

## SPECIFICATION

Specification No	:	<b>GW.11</b>
Part No.	:	<b>GW.11.A153</b>
Product Name	:	2.4GHz 1.8dBi Screw mount Dipole Antenna
Description	:	RP-SMA(M) Connector Hinged TPE Housing Length 84mm ROHS Compliant



## 1.0 Introduction

The GW.11 2.4 GHz dipole RP-SMA plug mount antenna is ideal for 2.4 GHz wireless applications such as Bluetooth and Wireless LAN. At only 84mm in length omni-directional 1.8dBi gain across all bands ensures constant reception and transmission. The antenna structure is designed for robust handling and the housing is made with TPE giving superior environmental reliability and a quality finish. The antenna can be rotated 90 degrees on the base hinge for ease of placement. Connector mount is fully customizable.

## 2.0 Electrical Properties

1.1	Frequency	2.4 GHz ~ 2.5 GHz
1.2	Gain (peak)	1.8 dBi
1.3	V.S.W.R	2.0 Max
1.2	Return Loss	- 10 dB Maximum
1.3	Radiation	Omni-directional
1.4	Polarization	Linear Vertical
1.5	Power Handling	1W

## 3.0 Mechanical Properties

2.1	Cable	RG-178 Coaxial Cable
2.2	Antenna Cover	TPE
2.3	Antenna Base	PC & PBT
2.4	Operating Temperature	-20°C ~ + 85°C
2.5	Storage Temperature	-30°C ~ + 85°C
2.6	Color	Black
2.7	Connector	RP-SMA(M)

## 4.0 Outline Drawings and Structure

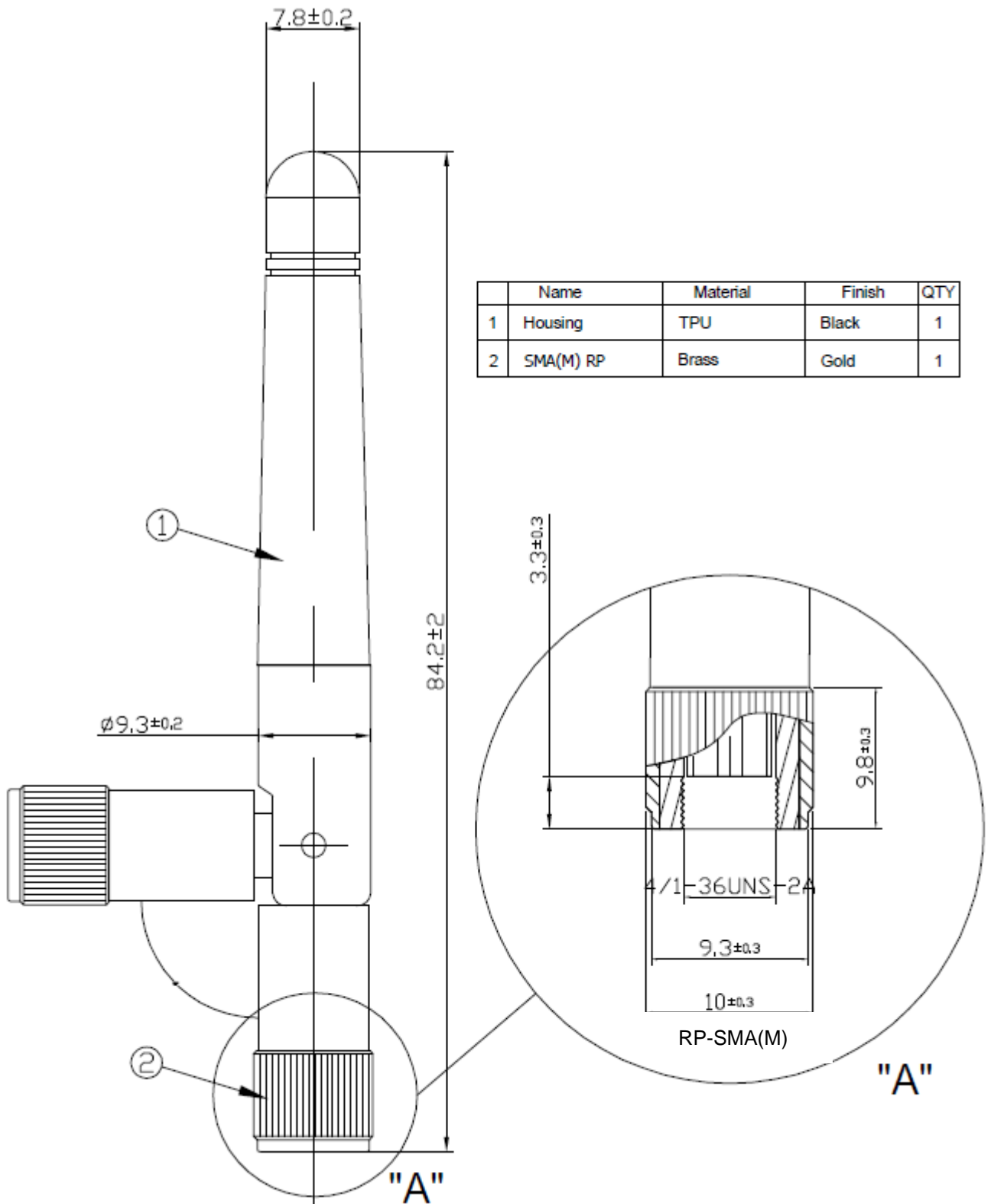

## 5.0 Measurements

### 5.1 Return Loss

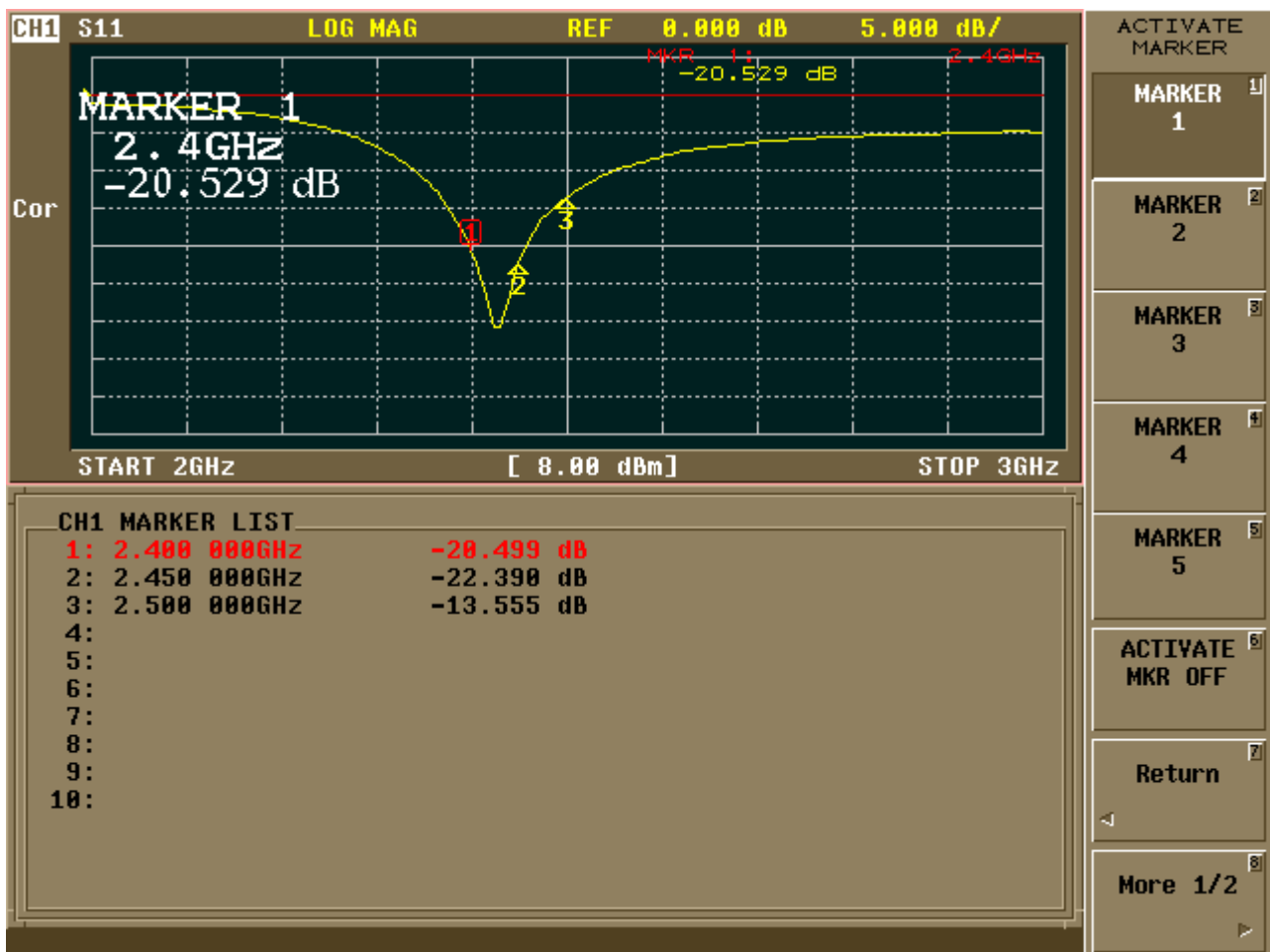

## 5.2 VSWR

