



# TAOGLAS®



## Datasheet

### 6 Inch Full Range Dual Cone Speaker – 4 Ohm

**Part No:**  
**SPKR.6.4.A**

#### **Description:**

6 Inch Full Range Dual Cone Speaker - 4 Ohm 35W RMS  
Rugged design for installation in a wide range of vehicles

#### **Features:**

4 Ohm Impedance  
Rated Input Power 35W RMS  
Max Input Power 70W Peak  
Sensitivity 87 dB 1W @ 1m  
Dimensions: 158 x 158 x 54 mm  
Connector: Packard Electric 12052832  
RoHS & Reach Compliant

1.	Introduction	3
2.	Specifications	4
3.	Frequency Response and Impedance Plots	5
4.	Mechanical Drawing	6
5.	Packaging	7
	Changelog	8

Taoglas makes no warranties based on the accuracy or completeness of the contents of this document and reserves the right to make changes to specifications and product descriptions at any time without notice. Taoglas reserves all rights to this document and the information contained herein. Reproduction, use or disclosure to third parties without express permission is strictly prohibited.

Copyright © Taoglas Ltd.



## 1. Introduction



Featuring a rugged design, in an industry standard form factor enabling ease of installation in a wide range of vehicles, with high levels of long term reliability and best in class performance Taoglas products are known for.

Our 6 Inch Dual Cone Full Range Speaker offers response optimized for voice and high sensitivity, with 4 Ohm impedance and power handling of 35W RMS and 70W Peak. Proven performance in demanding environments including heavy duty trucks and industrial and agricultural equipment. Taoglas added speakers to our product portfolio to provide both high quality connectivity and high quality audio solutions from one trusted company.

Please contact your regional Taoglas customer service team for more information and installation guidelines.

## 2. Specifications

Electrical / Acoustic	
Rated Impedance	4 Ohms +/- 10% Ohms
Frequency Response	90 Hz – 10,000 Hz +/- 6 dB
Sensitivity	87 dB 1W @ 1m
Maximum SPL	102 dB Continuous / 105 dB Peak @ 1m
Rated Input Power	35 Watts RMS (AES Continuous)
Maximum Input Power	70 Watts Peak (IEC Short Term)
Recommended Amplifier Power	35 Watts FTC
Optimal Enclosure Volume (Sealed)	58 Liters
Optimal Enclosure Volume (Ported)	15 Liters
Resonant Frequency	94 Hz +/- 10% Hz at Rated Input Power
Distortion	3.3% @ 1 kHz at Rated Input Power
Mechanical	
Dimensions	158 x 158 x 54 mm
Weight	0.54 kg
Connector	Packard Electric 12052832
Environmental	
Temperature Range	-40°C to 85°C
Humidity	Non-condensing 65°C 95% Relative Humidity



## 3. Frequency Reponse and Impedance Plots

### 3.1 Frequency Response

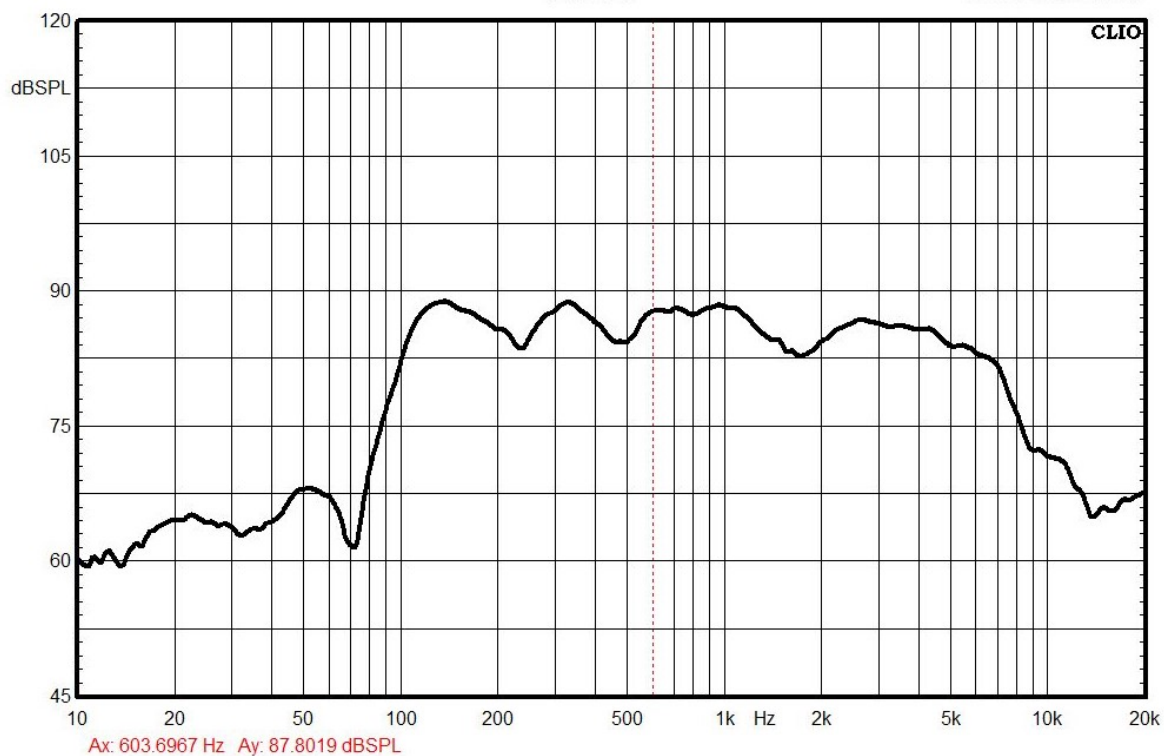

### 3.2 Impedance

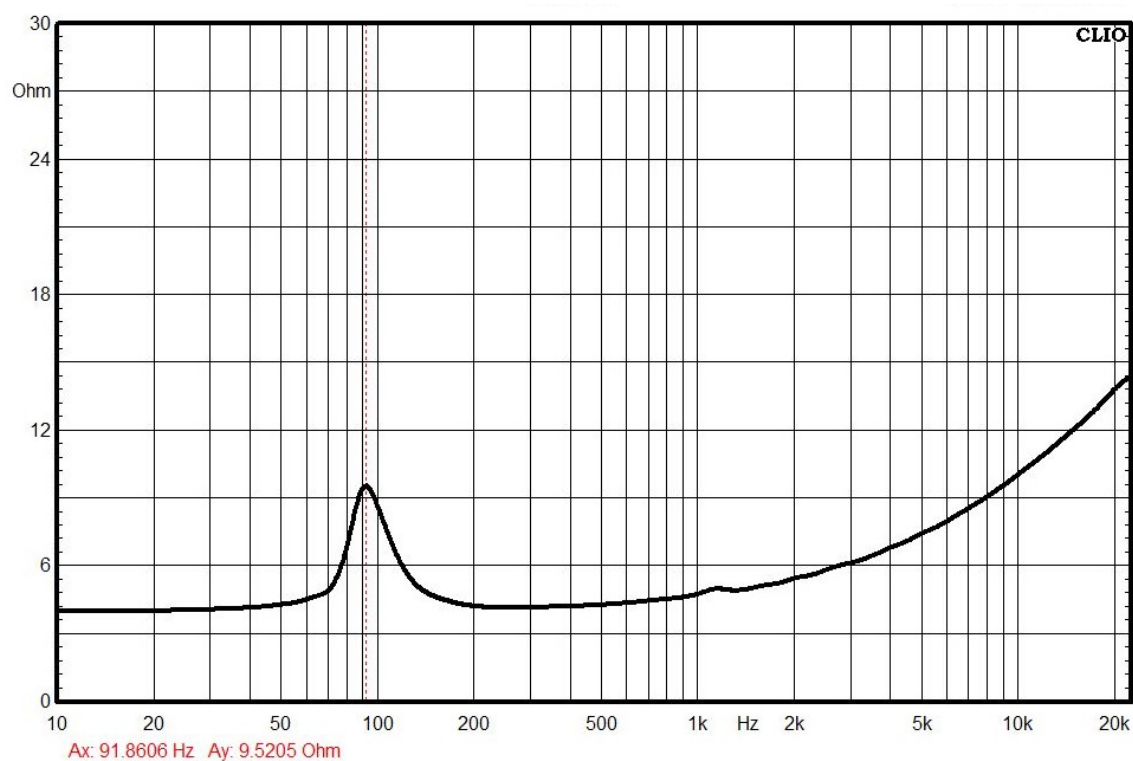

## 4. Mechanical Drawing (Units: mm)

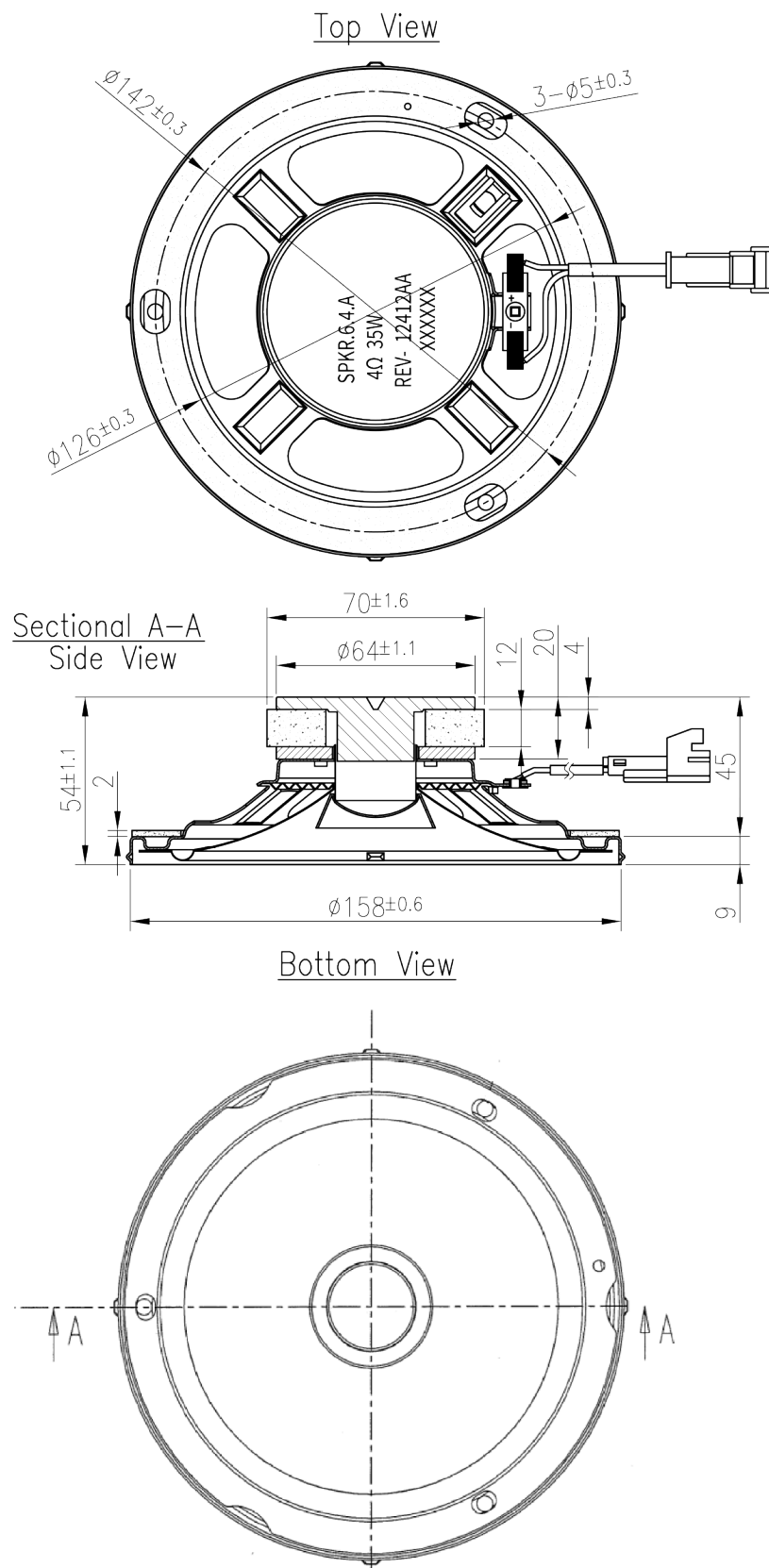

## 5. Packaging

1pcs SPKR.6.4.A per carton  
Dimensions – 165 x 165 x 62mm  
Weight – 0.62Kg

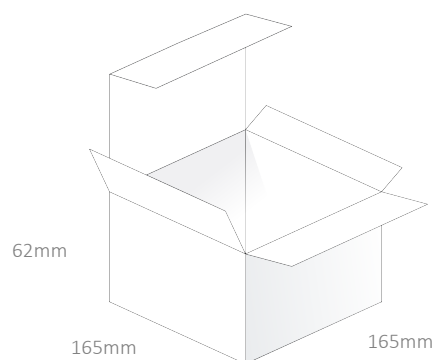

18pcs SPKR.6.4.A per carton  
Dimensions – 523 x 420 x 175mm  
Weight – 13Kg

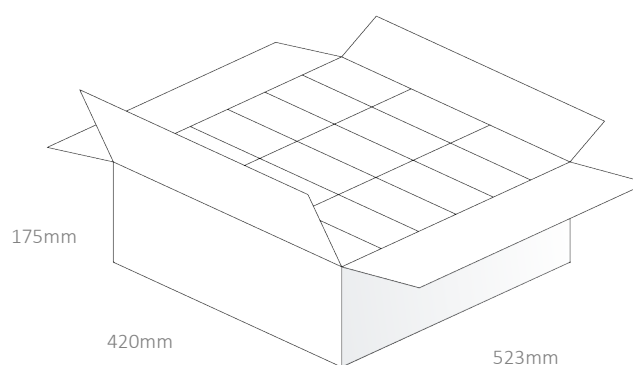

## Changelog for the datasheet

### SPE-19-8-041 – SPKR.6.4.A

#### Revision: E (Current Version)

Date:	2022-12-16
Changes:	Updated Specifications, Frequency Response Plot, and Impedance Plot, based on third party testing.
Changes Made by:	Mark Brown

#### Previous Revisions

##### Revision: A

Date:	2019-05-02
Changes:	Initial Release
Changes Made by:	Jack Conroy

##### Revision: B

Date:	2019-09-12
Changes:	Updated Drawing
Changes Made by:	Jack Conroy

##### Revision: C

Date:	2021-07-13
Changes:	Updated Mechanical Drawing
Changes Made by:	Gary West

##### Revision: D

Date:	2022-7-05
Changes:	Updated Specifications
Changes Made by:	Cesar Souza



[www.taoglas.com](http://www.taoglas.com)

